

AV Pre-Amplifier

CX-A5000

Setup Guide

English

This document explains how to set up a 11.2-channel system and play back surround sound from a BD/DVD on the unit.



To reduce the impact on natural resources, the Owner's Manual for this product is supplied on CD-ROM. For more information about this product, refer to the Owner's Manual on the supplied CD-ROM.



PDF versions of this guide and "Owner's Manual" can be downloaded from the following website.

<http://download.yamaha.com/>

[For U.S. customers only]

Visit the following website for additional information, FAQ's, downloads such as "Owner's Manual" and product updates.

<http://usa.yamaha.com/support/>

1 Preparation

Accessories

Check that the following accessories are supplied with the product.

Remote control



Batteries (x4)

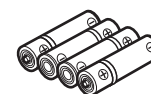

AAA, LR03, UM-4

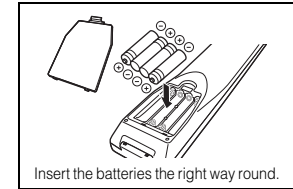

AM antenna



FM antenna



YPAO microphone



*One of the above is supplied depending on the region of purchase.

Microphone base



*Using for angle measurement during YPAO.

Power cable



*The supplied power cable varies depending on the region of purchase.

CD-ROM (Owner's Manual)



Safety Brochure



Setup Guide



• The illustrations of the main unit used in this guide are of the U.S.A. model, unless otherwise specified.

Cables required for connections

The following cables (not supplied) are required to build the system described in this document.

For connecting subwoofers, a TV and a BD/DVD player to the unit

- HDMI cable (x2)
- Audio pin cable (x2)
- Digital optical cable or stereo pin cable (x1*)
 - * Not required if your TV supports ARC (Audio Return Channel)

For connecting a power amplifier to the unit

- Audio pin cable (RCA unbalanced cable) (x11) or XLR balanced cable (x11)

For connecting speakers to a power amplifier

- Speaker cable (x11)

2 Connecting a power amplifier, speakers and subwoofers

Connect a power amplifier and subwoofers (with built-in amplifier) to the unit, and speakers to the power amplifier.

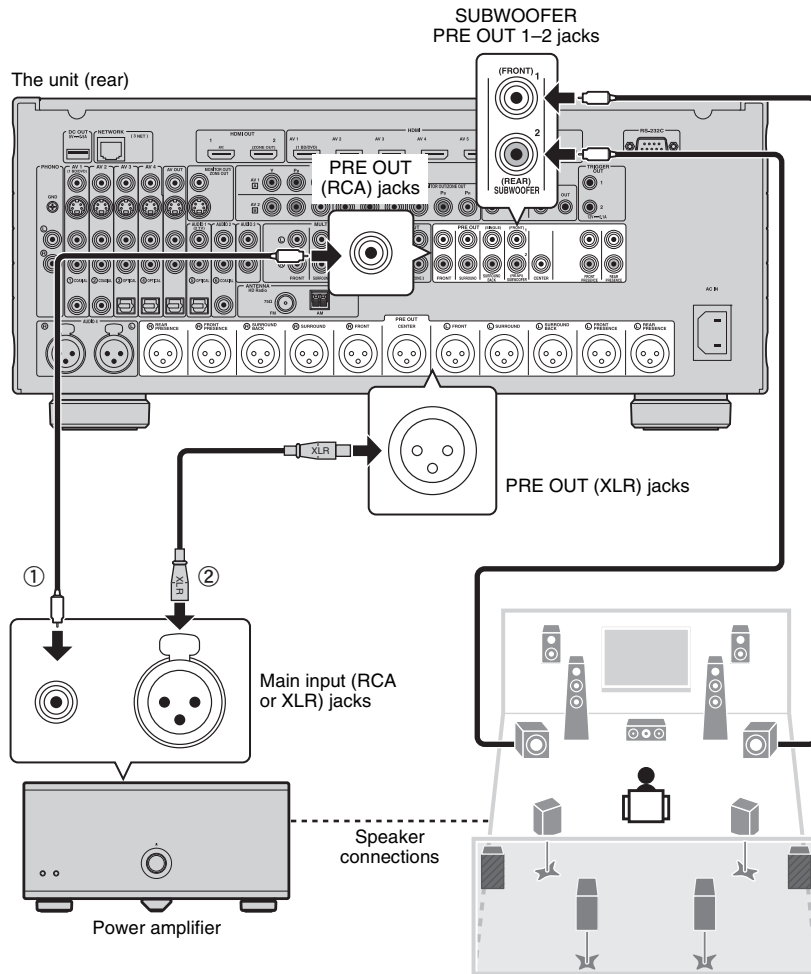

- Use a subwoofer equipped with built-in amplifier.
- Before connecting a power amplifier and subwoofers to the unit, remove the power cables of the unit, power amplifier and subwoofers from the AC wall outlets.
- The pin assignments for the XLR output jacks of the unit are shown below. Before connecting an XLR balanced cable, refer to the instruction manual of your device and verify that its XLR jacks are compatible with the pin assignments.

XLR output jacks

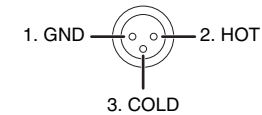

1 Connect the PRE OUT jack of the unit to the main input jack of the power amplifier for each of 11 channels (① or ②).

When making unbalanced connections (①), connect PRE OUT (RCA) jacks of the unit to the main input (RCA) jacks of the amplifier with audio pin cables (RCA unbalanced cables).

When making balanced connections (②), connect PRE OUT (XLR) jacks of the unit to the main input (XLR) jacks of the amplifier with XLR balanced cables.

2 Connect the subwoofers (with built-in amplifier) to the SUBWOOFER PRE OUT 1-2 jacks of the unit with audio pin cables.

3 Connect each speaker to the corresponding speaker terminal of the power amplifier.

For details on speaker connections, refer to the instruction manuals for your power amplifier and speakers.



- Depending on your power amplifier, you may be required to change its settings so that audio received from the unit is come from the speakers connected to the amplifier.
- You can connect 2 subwoofers to the unit and place them on the right/left (or front/rear) sides of the room. When using 2 subwoofers, configure the "SWFR Layout" setting after connecting the power cable to an AC wall outlet. For details, refer to "Owner's Manual".
- If you have a Yamaha power amplifier that supports the trigger function (such as MX-A5000), you can control the power amplifier in conjunction with operating the unit (such as powering on/off) by making a system connection. For details, refer to "Owner's Manual".

3 Connecting external devices

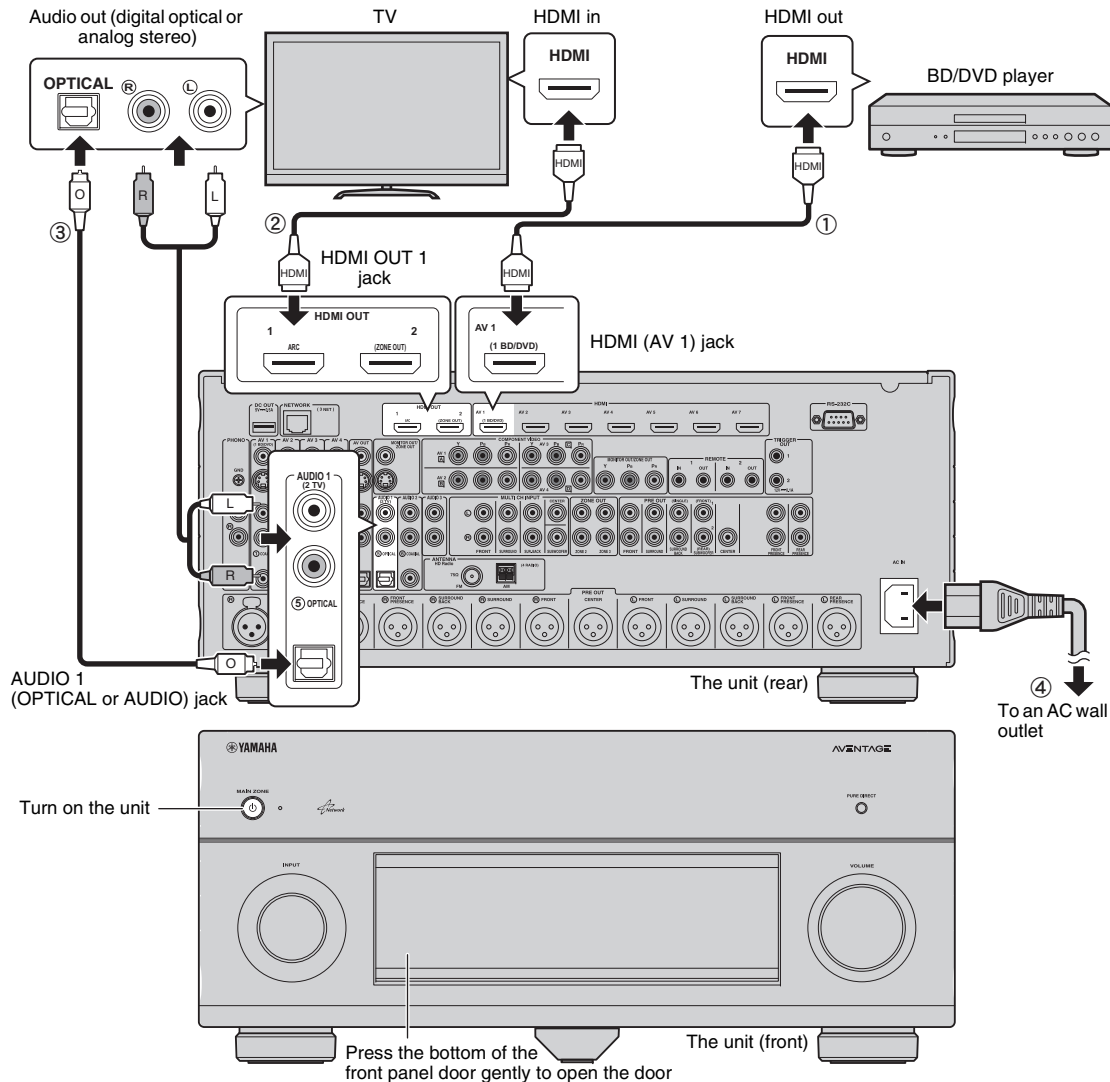

1 Connect external devices to the unit.

- ① Connect a BD/DVD player to the unit with an HDMI cable.
If the BD/DVD player is currently connected to the TV directly with an HDMI cable, disconnect the cable from the TV and connect it to the unit.
- ② Connect a TV to the unit with the other HDMI cable.
- ③ Connect a TV to the unit with a digital optical cable or a stereo pin cable.
This connection is required to play back TV audio on the unit. This connection is not required if your TV supports ARC (Audio Return Channel).
- ④ Connect the supplied power cable to the unit and then to an AC wall outlet.



• For information on how to connect radio antennas or other external devices, see "PREPARATIONS" in "Owner's Manual".

2 Turn on the unit, power amplifier, TV and BD/DVD player.

3 Use the TV remote control to change the TV input to video from the unit.

The connections are complete. Proceed to the next page to optimize the speaker settings.



• You can select the on-screen menu language from English (default), Japanese, French, German, Spanish, Russian, Italian and Chinese. For details, refer to "Owner's Manual". In this guide, illustrations of English menu screens are used as examples.

4 Optimizing the speaker settings automatically (YPAO)

The Yamaha Parametric room Acoustic Optimizer (YPAO) function detects speaker connections, measures the distances from them to your listening position(s), and then automatically optimizes the speaker settings, such as volume balance and acoustic parameters, to suit your room.

- During the measuring process, test tones are output at high volume. Ensure that the test tones do not frighten small children. Also, refrain from using this function at night when it may be a nuisance to others.
- During the measuring process, you cannot adjust the volume.
- During the measuring process, keep the room as quiet as possible.
- Do not connect headphones.
- Do not stand between the speakers and the YPAO microphone during the measurement process (about 3 minutes).
- Move to the corner of the room or leave the room.

Preparing for YPAO

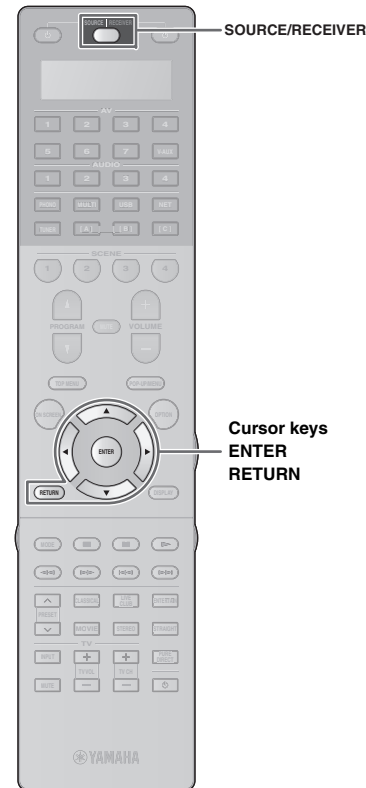
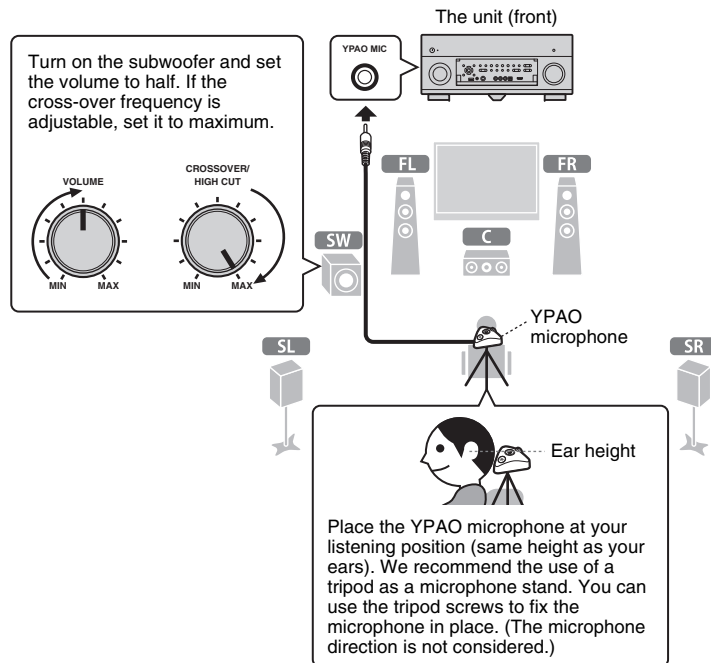

1 Connect the YPAO microphone to the YPAO MIC jack on the front panel.

The following screen appears on the TV.

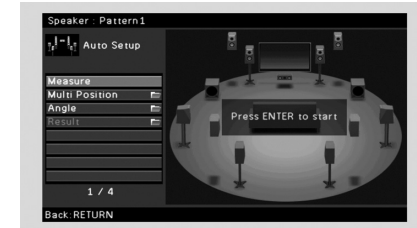

- To cancel the operation, disconnect the YPAO microphone before starting the measurement.

2 To start the measurement, use the cursor keys to select “Measure” and press ENTER.

The measurement will start in 10 seconds.

The following screen appears on the TV when the measurement finishes.

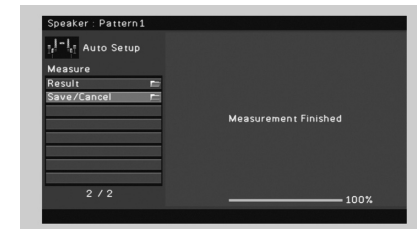

- If the cursor keys do not work, press SOURCE/RECEIVER (to light up the key in orange) and then use the cursor keys.
- If any error message (such as E-1) or warning message (such as W-2) appears, see “Error messages” or “Warning messages” in “Owner’s Manual”.
- If the warning message “W-1:Out of Phase” appears, see “If “W-1:Out of Phase” appears” (next page).

3 Use the cursor keys to select “Save/Cancel” and press ENTER.

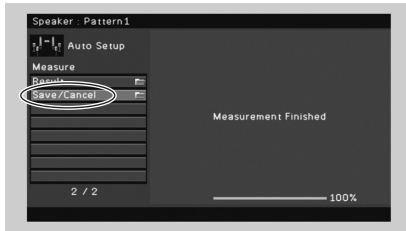

4 Use the cursor keys to select “SAVE” and press ENTER.

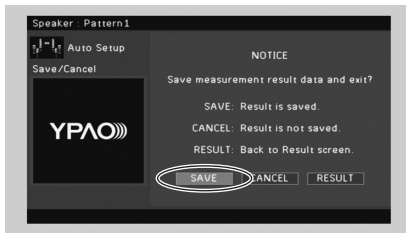

5 Disconnect the YPAO microphone from the unit.

This completes optimization of the speaker settings.

- The YPAO microphone is sensitive to heat, so should not be placed anywhere where it could be exposed to direct sunlight or high temperatures (such as on top of AV equipment).

If “W-1:Out of Phase” appears

Follow the procedure below to check the speaker connections.

When you have made balanced connections

- The XLR balanced jacks of your power amplifier may not be compatible with the pin assignments of the unit. In this case, turn off the power amplifier, change its pin assignment setting or use unbalanced connections, and then try YPAO measurement again.

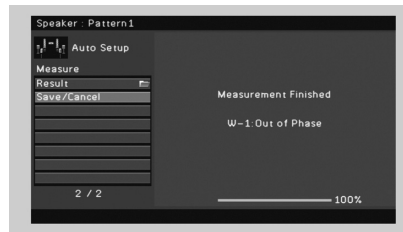

- ① Use the cursor keys to select “Result” and press ENTER.
- ② Use the cursor keys to select “Wiring”.
- ③ Check the cable connections (+/-) of the speaker that was identified as being “Reverse” in the warning message.

If the speaker is connected correctly:

Depending on the type of speakers or room environment, this message may appear even if the speakers are connected correctly.

In this case, you can ignore the message.

Press RETURN and proceed to step 3.

If the speaker is connected incorrectly:

Turn off the unit, reconnect the speaker cable, and then try YPAO measurement again.

5 Playing back a BD/DVD

Now let's play back a BD/DVD.

We recommend playing back multichannel audio (5.1-channel or more) to feel surround sound produced by the unit.

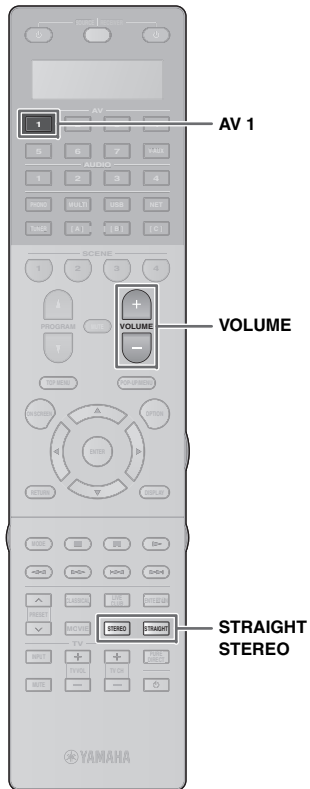

AV 1

VOLUME

STRAIGHT
STEREO

- 1 Press **AV 1** to select “AV 1” as the input source.



- 2 Start playback on the BD/DVD player.

- 3 Press **STRAIGHT** repeatedly to select “STRAIGHT”.



- To check if sounds are properly heard from all speakers, press **STEREO** repeatedly to select “9ch Stereo”.

- 4 Press **VOLUME** to adjust the volume.



This completes the basic setup procedure.

If surround sound is not working

Sound is only being output from the front speakers during multichannel audio playback

Check the digital audio output setting on the BD/DVD player.

It may be set to 2-channel output (such as PCM).

No sound is coming from a specific speaker

See “Troubleshooting” in “Owner’s Manual”.

Many more features!

The unit has various other functions.

Please refer to “Owner’s Manual” on the supplied CD-ROM to help you get the most out of the unit.

Connecting other playback devices

Connect audio devices (such as CD player), game consoles, camcorders, and many others.

Selecting the sound mode

Select the desired sound program (CINEMA DSP) or surround decoder suitable for movies, music, games, sports programs, and other uses.

Playing back from iPod

By using a USB cable supplied with iPod, you can enjoy iPod music on the unit.

- Listening to FM/AM radio
- Playing back music stored on a USB storage device
- Playing back the network contents
- Selecting the input source and favorite settings at once

For more information, see “What you can do with the unit”.

